



150 SF to 5000 SF Offices For Lease

Locate your office inside of a world class data center
in Norcross, Georgia



Contact: Chris Harpenau
678-735-0100
chris@summitgeorgia.com

Data Center Office Space for Lease

Locate your office in a world class data center

- 150-5,000 SF Floor Plan Options
- Lease Rates from \$18/SF
- Build to Suit Interior Finish
- Short Term Leases
- Conference Room Access
- Kitchen and Break Room Access
- 24 Hour Security
- Co-location, Data Storage Available
- Fiber, Disaster Recovery on site
- Redundant Back Up Power
- Convenient Location just off of I-85

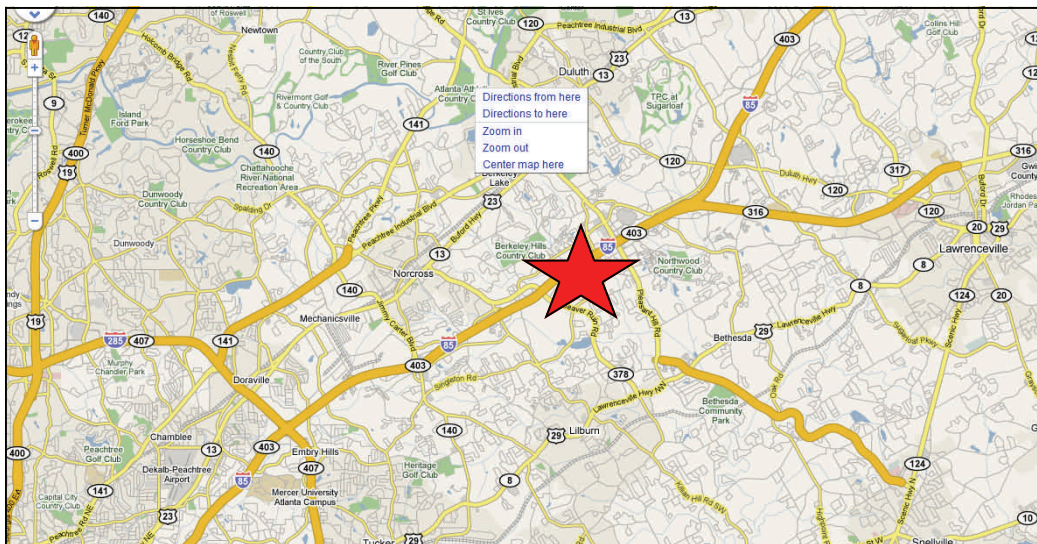

4311 Communications Drive, Norcross GA 30093

Contact: Chris Harpenau
678-735-0100
chris@summitgeorgia.com

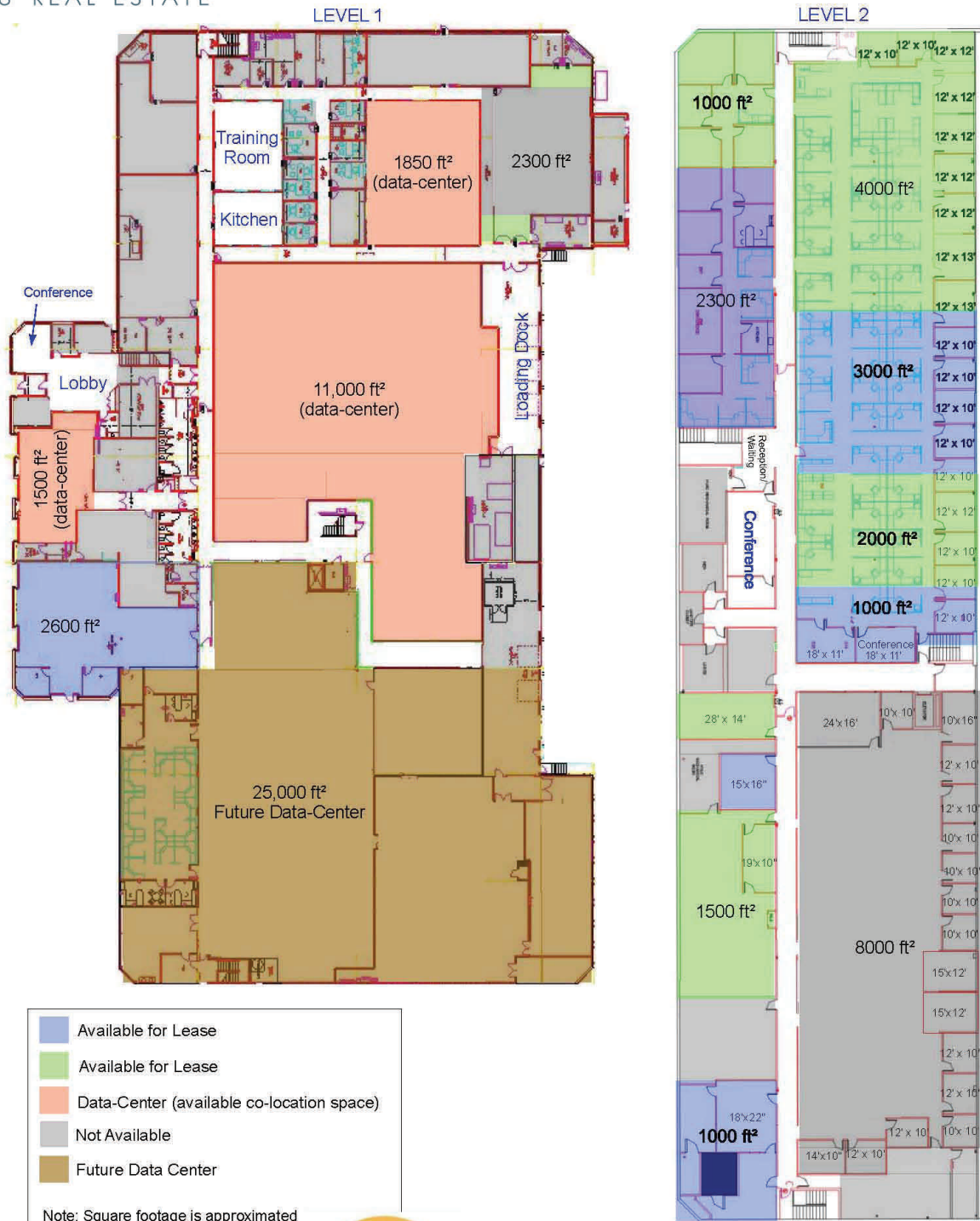

SAGO NETWORKS

The Internet Solutions Company
www.sagonet.com



Contact: Chris Harpenau
678-735-0100
chris@summitgeorgia.com



Location

Our Atlanta facility is located on Communications Drive about 20 miles from downtown Atlanta. This is our newest facility and sports plenty of data-center space for customer use. If you would like your server hosted here, please let us know in the notes field of your order form.

Facility

The Atlanta facility is 110,000 square feet. This area is segregated into multiple data-centers, office space for our technicians, with the rest separated into suites and office space of varying sizes.

Security

This facility is protected by both a 24/7 security guard as well as security cameras which are connected to a digital time-lapse recording system. In addition to the cameras, the building requires digital key-card entry at every door. To gain access to the data-center itself, you must swipe a keycard at three doors.

Physical security into any Sago Networks facility is several levels. All employees, customers and contractors are restricted to the necessary levels of access determined by job function and service. All customers are required to provide a government issued ID card/driver's license to place on file before being allowed into the facility.

Any persons not identified with a company prior to coming to a Sago Networks facility will be asked to provide identification and Sago Networks will contact the person of authorization for the account before access is granted. Customer's entering the facility are required to sign in with network operations center personnel and will be let into the facility by a network operations center employee.

Power

The power needs of a facility such as this is tremendous. While the space available at our facilities is extensive, it is nothing without the power infrastructure to sustain it. Each of Sago Networks facilities has diverse power feeds, redundant generators, and N+2 UPS systems. The power system is further carried by PMM (Power Management Module) systems.

Environment

When considering co-locating equipment or leasing a dedicated server, environmental conditions are a major consideration in your choice. Sago Networks has over 200 tons of CRAC (Computer Room Air Conditioning) in it's facilities. CRAC equipment is also setup in an N+2 configuration to make sure that any CRAC equipment failure has no impact of the environmental conditions in the co-location and server farm areas. The CRAC equipment also monitors and maintains the humidity of each area, ensuring your equipment is never negatively impacted.

Contact: Chris Harpenau
678-735-0100
chris@summitgeorgia.com